

4300 Storefront Framing System

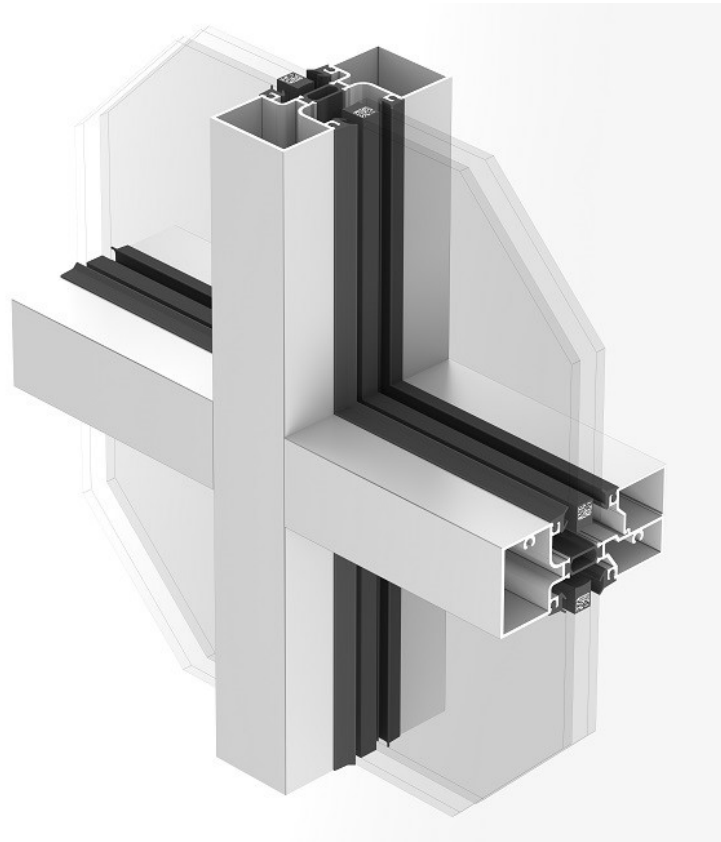

PRODUCT FEATURES

- High-performance polyamide thermal break
- Options to exterior glazing or interior glazing
- Full rain screen system to allow water go out
- Durable EPDM seal gaskets on exterior and interior
- Hidden screws design
- Setting for either double glazing and single sheet glazing
- Standard finish in clear anodized and black anodized, options to different colors on exterior and interior
- Flexible to custom design and unlimited integration to standard and/or any sizes of doors and vents

4300 Storefront Framing System

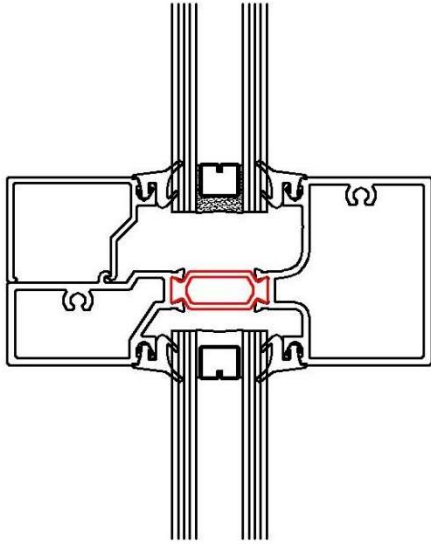

HORIZONTAL MULLION

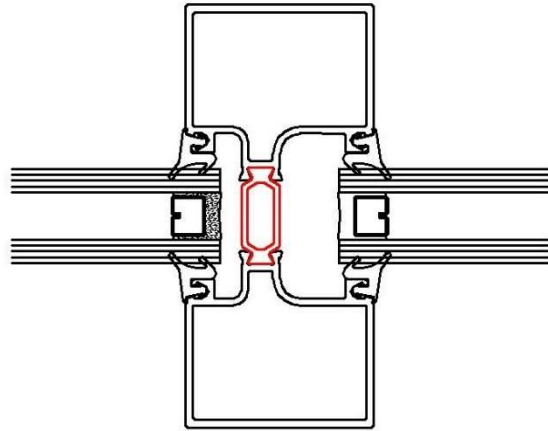

VERTICAL MULLION

SIZE DETAILS

Frame Depth	Sightline	Thermal Break Depth	Glass Overall Thickness
114.3mm (4 1/2")	50.8mm (2")	26.0mm (1")	Double Glazed 25.4mm (1") Single sheet glazed from 6mm to 10mm (1/4" to 3/8")

PERFORMANCE

Product designation	Air Leakage Resistance	Water Penetration Resistance	Uniform Load Deflection	Uniform Load Structural	Forced-entry Resistance	U-factor
Class CW-PG50	0.030 L/s/m ² (0.006 cfm/ft ²) @ 75 Pa (1.57psf) 0.076 L/s/m ² (0.015 cfm/ft ²) @ 300 Pa (6.27psf)	720 Pa (15.04psf)	Design 2400 Pa (50psf)	Design: 2400 Pa(50psf)	F10 rating	See U-factor Table